



**SISTEMAS MODULARES
PARA CABINES
SANITÁRIAS /
SANITARY BOOTH
HARDWARE /
HERRAJES PARA
CABINAS SANITÁRIAS.**

SISTEMAS MODULARES PARA CABINES SANITÁRIAS / SANITARY BOOTH HARDWARE / HERRAJES PARA CABINAS SANITÁRIAS.

A JNF tem uma gama completa de ferragens em aço inox para construção de módulos sanitários ou cabines em painéis "HPL".

As ferragens são fabricadas em aço inox EN 1.4301 e EN 1.4401, no acabamento escovado.

De forma a adaptar estes sistemas a qualquer tipo de decoração de interiores, as ferragens podem ser produzidas com um acabamento superficial de PVD TITÂNIO o que permite adicionar cor, para além do aumento da resistência à corrosão e aos riscos.

Todas as ferragens são aplicáveis a painéis "HPL" de 13 ou 10mm de espessura.

A estrutura aérea de estabilização dos painéis pode ser tubular de Ø19 e Ø25mm, quadrada 20x20mm ou em perfis de alumínio.

JNF has a complete range of stainless steel fittings for the construction of sanitary modules or cabins in "HPL" panels.

The fittings are made in stainless steel EN 1.4301 and EN 1.4401 satin finish.

In order to adapt these systems to any type of interior decoration, the hardware can be produced with a surface finish of TITANIUM PVD which allows to add color, in addition to the increased resistance to corrosion and scratches.

All hardware is applicable to "HPL" panels of 13 or 10mm thick.

The aerial stabilizing structure of the panels can be tubular Ø19 and Ø25mm, square 20x20mm or in aluminum profiles.

JNF tiene una gama completa de herrajes en acero inoxidable para la construcción de módulos sanitarios o cabinas en paneles "HPL".

Los herrajes se fabrican en acero inoxidable EN 1.4301 y EN 1.4401, en el acabado satin.

De forma a adaptar estos sistemas a cualquier tipo de decoración de interiores, los herrajes pueden ser producidos con un acabado superficial de PVD TITANIO que permite añadir color, además del aumento de la resistencia a la corrosión ya lo rayado.

Todos los herrajes se aplican a los paneles HPL de 13 o 10 mm de espesor.

La estructura aérea de estabilización de los paneles puede ser tubular de Ø19 y Ø25mm, cuadrada 20x20mm o en perfiles de aluminio.

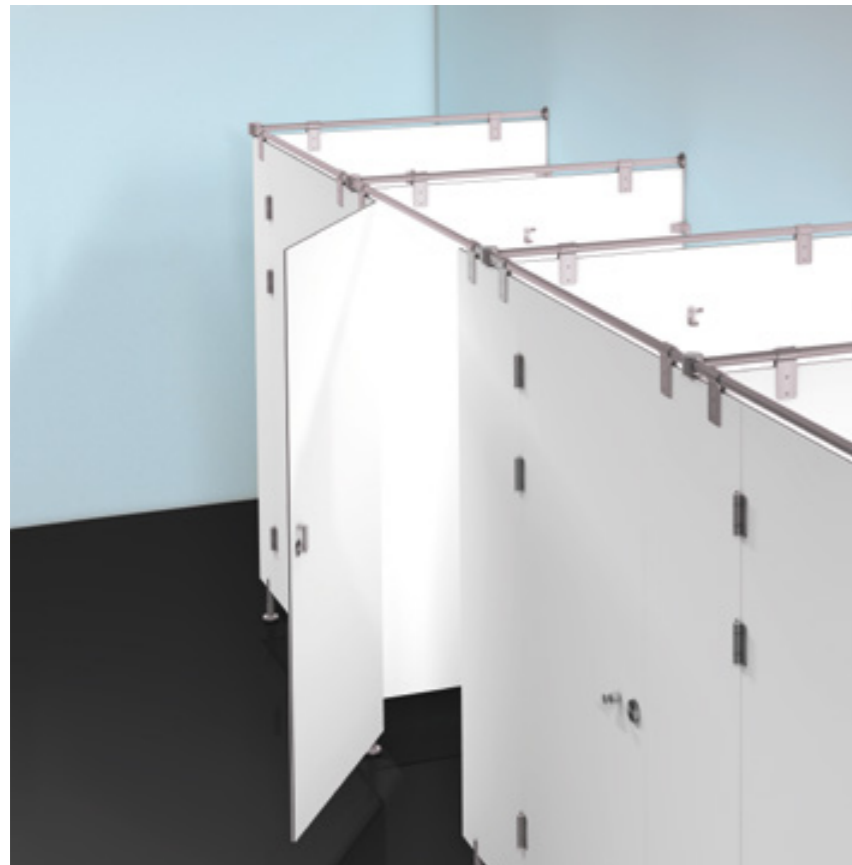
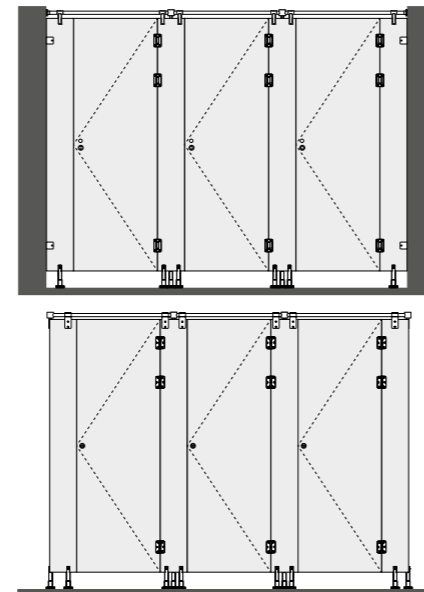
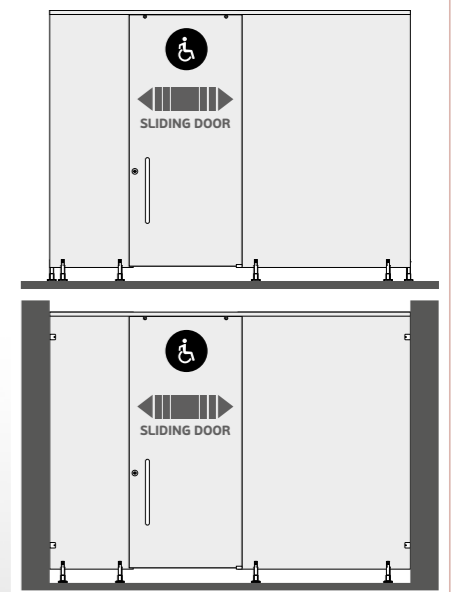
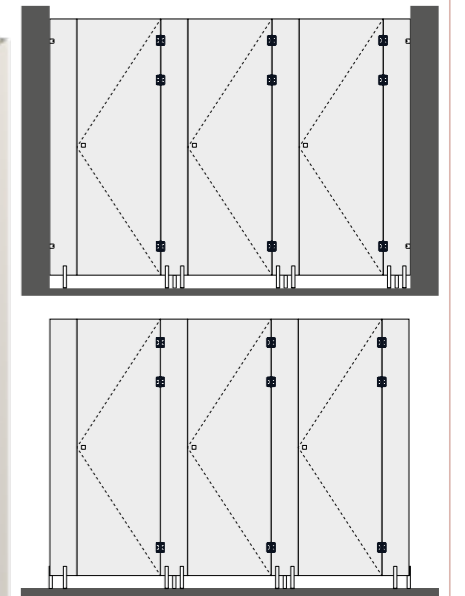
 20x20
mm

SISTEMAS MODULARES PARA CABINES SANITÁRIAS / SANITARY BOOTH HARDWARE / HERRAJES PARA CABINAS SANITÁRIAS.

SM.017

Base regulável para painel /
 Adjustable foot / Pie regulable.

Base para painel fabricada em aço inox EN 1.4401 e EN 1.4301. Fixação ao solo através de uma sólida base metálica. O ajuste do suporte em altura é possível mesmo com a base já fixa ao solo e o painel já instalado. / Adjustable foot made in stainless steel EN 1.4401 and EN 1.4301. Fixing on the floor through a strong metallic base. The height it is adjustable even with the base already fixed on the floor and the panel on the support. Pie regulable fabricado en acero inox EN 1.4401 y EN 1.4301. Sujecion al suelo a través de sólida base metálica. El ajuste es posible mismo despues de la sujecion de la base al suelo y del panel en el soporte.



MATERIAL: EN 1.4301 / AISI 304

STANDARD FINISH: SATINADO / SATIN / SATIN

OPTIONAL: PVD TITANIUM COATED

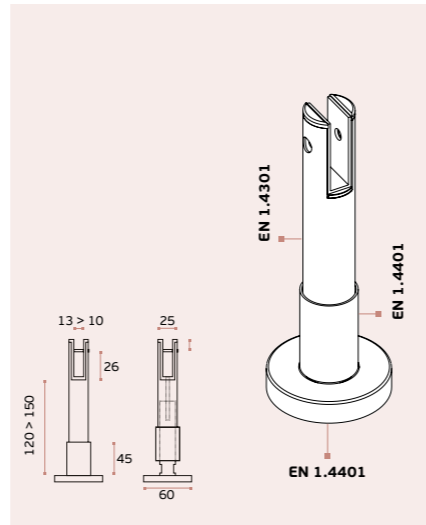

SM.017.XL /

Base regulável para painel /
 Adjustable foot / Pie regulable.

Base para painel fabricada em aço inox EN 1.4401 e EN 1.4301. Fixação ao solo através de uma sólida base metálica. O ajuste do suporte em altura é possível mesmo com a base já fixa ao solo e o painel já instalado. / Adjustable foot made in stainless steel EN 1.4401 and EN 1.4301. Fixing on the floor through a strong metallic base. The height it is adjustable even with the base already fixed on the floor and the panel on the support. Pie regulable fabricado en acero inox EN 1.4401 y EN 1.4301. Sujecion al suelo a través de sólida base metálica. El ajuste es posible mismo despues de la sujecion de la base al suelo y del panel en el soporte.



MATERIAL: EN 1.4301 / AISI 304

STANDARD FINISH: SATINADO / SATIN / SATIN

OPTIONAL: PVD TITANIUM COATED

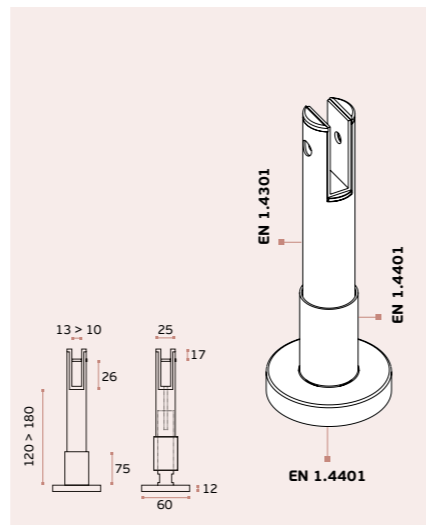

SM.025 ECO

SM.025.T TITANIUM
 Base regulável para painel /
 Adjustable foot / Pie regulable.

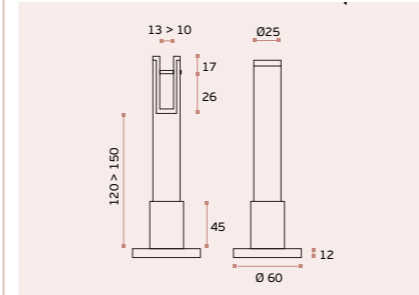

ECO series / TITANIUM

MATERIAL: AISI 201 / AISI 304

STANDARD FINISH: SATINADO / SATIN / SATIN

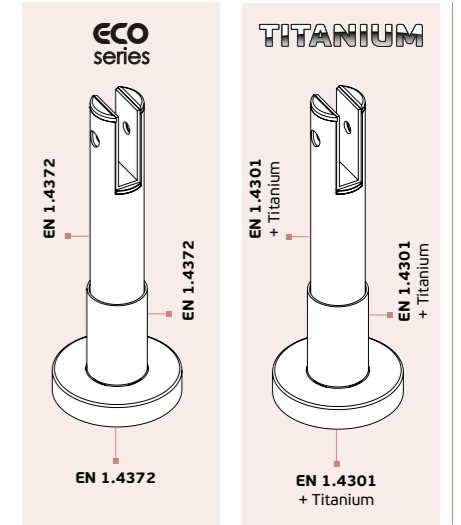

SM.070

Base quadrada para painel HPL 13mm.

Ajustável em altura por sistema nivelador oculto, permite o ajuste com o painel já instalado utilizando apenas o parafuso afinador na lateral da base. Todas as fixações ficam ocultas. A base de apoio ao pavimento em compósito resistente a agentes químicos. / Square base for panel "HPL" 13mm thickness. Height adjustable by concealed leveling system, allows adjustment with the panel already installed using only the tuner bolt on the side of the base. All the fixings are hidden. The support base for the floor in made in composite resistant to chemical agents / Base cuadrada para panel "HPL" 13mm.

Ajustable en altura por sistema nivelador oculto, permite el ajuste con el panel ya instalado utilizando sólo lo tornillo afinador en la lateral de la base. La base de apoyo al pavimento en composite resistente a agentes químicos. Todas las fijaciones quedan ocultas. /

MATERIAL: EN 1.4301 / AISI 304

ACABAMENTO / FINISH / ACABADO:
STANDARD: SATINADO / SATIN / SATIN

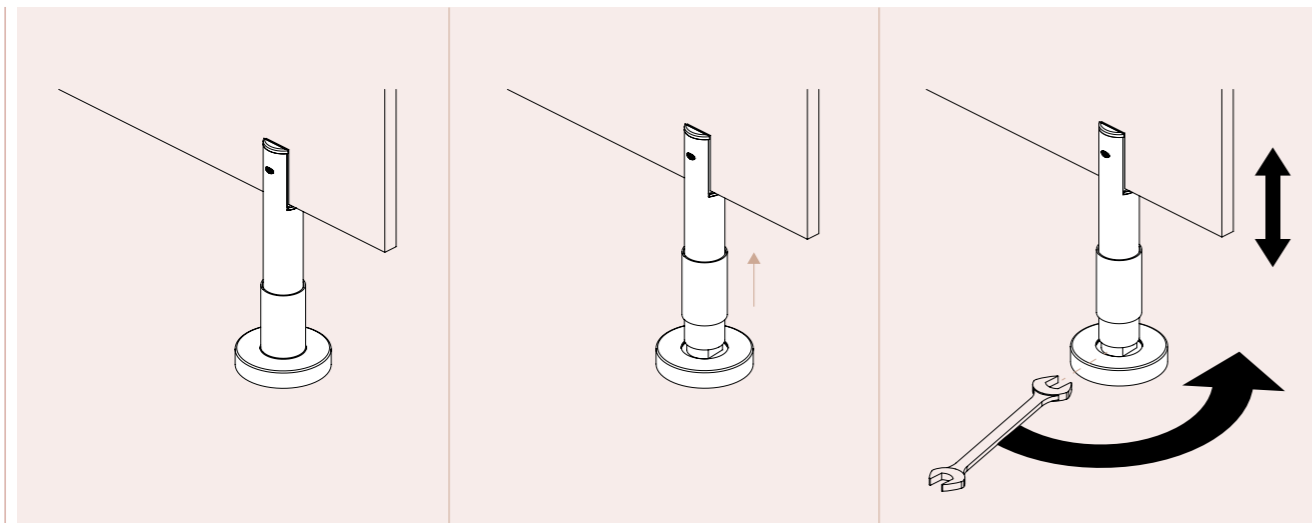
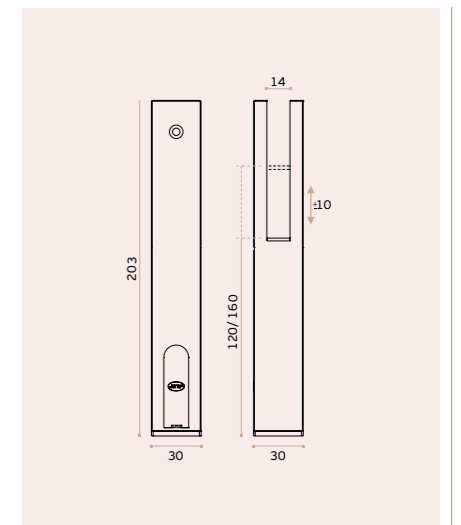

.TB
 PVD
 Titanium
 black

.TG
 PVD
 Titanium
 gold

.TCO
 PVD
 Titanium
 copper

.TCH
 PVD
 Titanium
 chocolate

.TB
 PVD
 Titanium
 black

.TG
 PVD
 Titanium
 gold

.TCO
 PVD
 Titanium
 copper

.TCH
 PVD
 Titanium
 chocolate

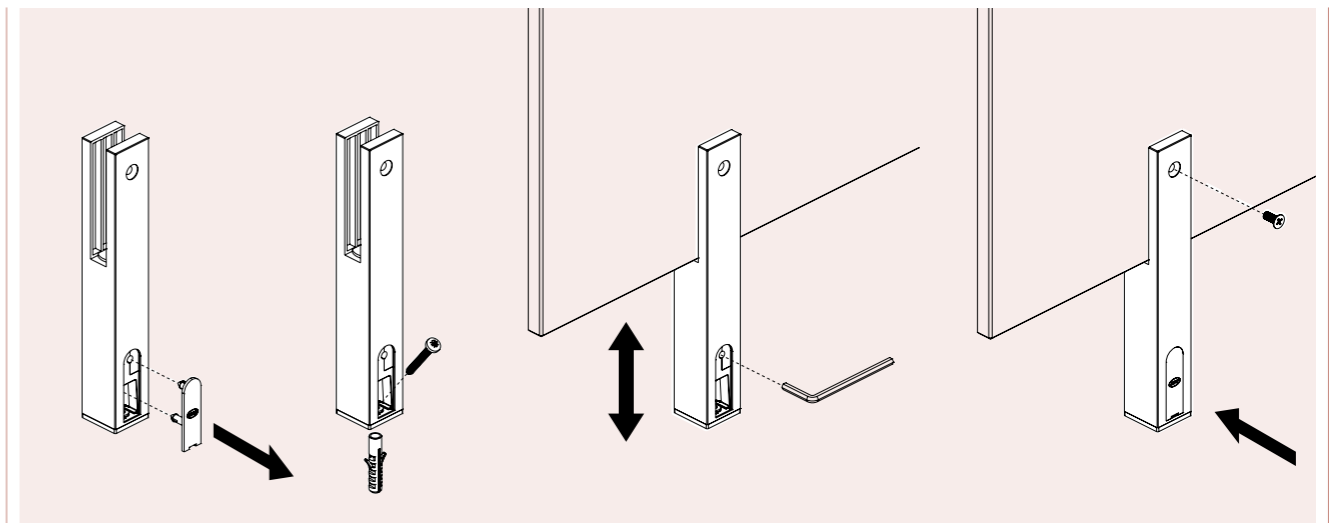

SISTEMAS MODULARES PARA CABINES SANITÁRIAS / SANITARY BOOTH HARDWARE / HERRAJES PARA CABINAS SANITÁRIAS.

SM.006.A1

Dobradiça (direita ou esquerda) /
 Lift off hinge (right or left hand) /
 Bisagra (derecha o izquierda).

.TB .TG .TCO .TCH

MATERIAL: EN 1.4301 / AISI 304

ACABAMENTO / FINISH / ACABADO:
STANDARD: SATINADO / SATIN / SATIN

OPTIONAL: PVD TITANIUM COATED

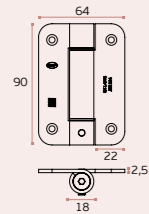

SM.006.A2

Dobradiça (direita ou esquerda) /
 Lift off hinge (right or left hand) /
 Bisagra (derecha o izquierda).

.TB .TG .TCO .TCH

MATERIAL: EN 1.4301 / AISI 304

ACABAMENTO / FINISH / ACABADO:
STANDARD: SATINADO / SATIN / SATIN

OPTIONAL: PVD TITANIUM COATED

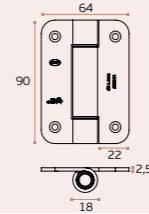

DOBRADIÇAS COM MOLA E FECHO SUAVE / HINGES WITH SPRING AND WITH SOFT CLOSE / BISAGRAS CON MUELLE Y CIERRE SUAVE

1 - Sistema de mola helicoidal /

Helicoidal spring system /
 Sistema de muelle helicoidal.

2 - Sistema de ajuste da força da mola /

Spring power adjustment /
 Sistema de ajuste de fuerza de lo muelle.

3 - Dois casquilhos poliméricos /

Two polymeric bushings /
 Dos bujes polimericos.

4 - Sistema de fecho suave /

Soft closing system /
 Sistema de cierre suave.

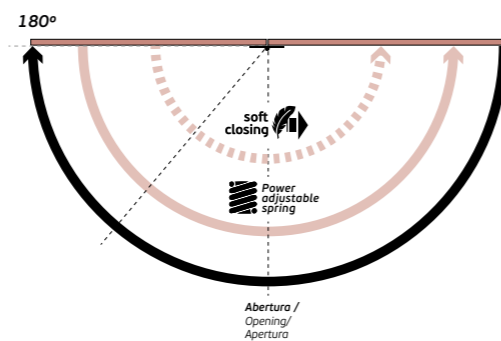

SM.005.C

Dobradiça com mola /
 Hinge with spring /
 Bisagra con muelle.



MATERIAL: EN 1.4301 / AISI 304

ACABAMENTO / FINISH / ACABADO:
STANDARD: SATINADO / SATIN / SATIN

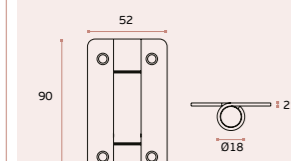

SM.005.B

Dobradiça /
 Hinge / Bisagra.

MATERIAL: EN 1.4301 / AISI 304

ACABAMENTO / FINISH / ACABADO:
STANDARD: SATINADO / SATIN / SATIN

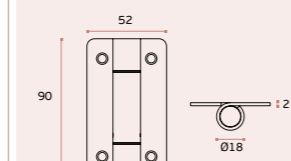

.TB
 PVD
 Titanium
 black

.TG
 PVD
 Titanium
 gold

.TCO
 PVD
 Titanium
 copper

.TCH
 PVD
 Titanium
 chocolate

.TB
 PVD
 Titanium
 black

.TG
 PVD
 Titanium
 gold

.TCO
 PVD
 Titanium
 copper

.TCH
 PVD
 Titanium
 chocolate

SM.005.D.ECO

Dobradiça /
 Hinge / Bisagra.

ECO
 series

MATERIAL: EN 1.4372 / AISI 201

ACABAMENTO / FINISH / ACABADO:
STANDARD: SATINADO / SATIN / SATIN

OPTIONAL: PVD TITANIUM COATED

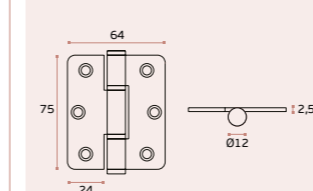

SM.006.B.TCO

Dobradiça /
 Hinge / Bisagra.

.TB .TG .TCO .TCH

MATERIAL: EN 1.4301 / AISI 304

ACABAMENTO / FINISH / ACABADO:
STANDARD: PVD TITANIUM COATED

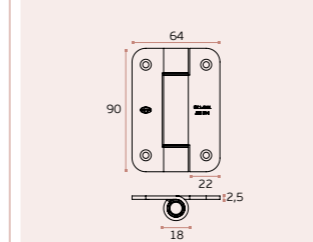

SM.005.A.ECO

Dobradiça (direita ou esquerda) /
 Lift off hinge (right or left hand) /
 Bisagra (derecha o izquierda).

ECO
 series

MATERIAL: EN 1.4372 / AISI 201

ACABAMENTO / FINISH / ACABADO:
STANDARD: SATINADO / SATIN / SATIN

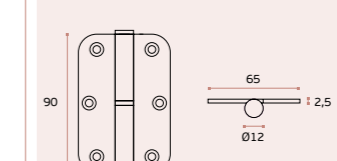

SM.006.B.TB
 EN 1.4301 + Titanium Black
 Satinado / Satin / Satin

SM.006.B.TCO
 EN 1.4301 + Titanium Copper
 Satinado / Satin / Satin

SM.006.B.TG
 EN 1.4301 + Titanium Gold
 Satinado / Satin / Satin

SM.006.B.TCH
 EN 1.4301 + Titanium Chocolate
 Satinado / Satin / Satin



SISTEMAS MODULARES PARA CABINES SANITÁRIAS / SANITARY BOOTH HARDWARE / HERRAJES PARA CABINAS SANITÁRIAS.

EASY FIX



SM.031

EN 1.4301 Satinado / Satin / Satin
Fecho com indicador "livre-ocupado" /
 Bathroom latch with indicator /
 Cierre de baño con indicador.

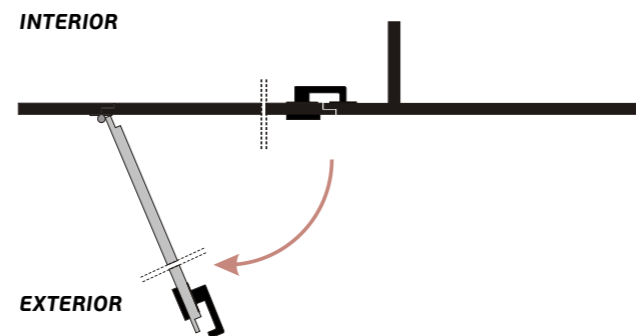
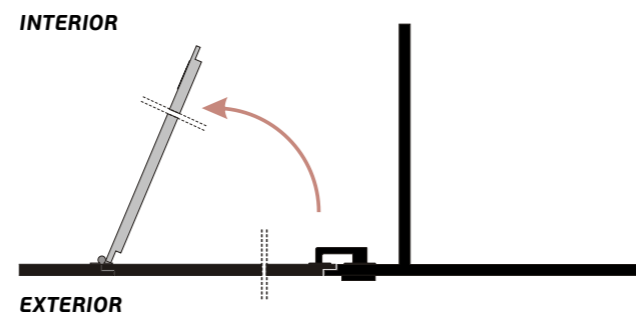
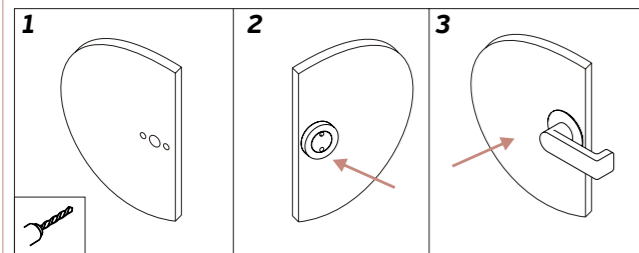

MODELO PATENTEADO / PATENTED MODEL / MODELO PATENTADO

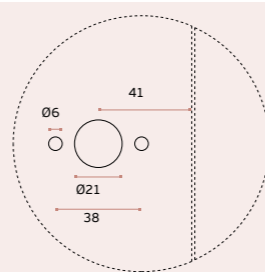
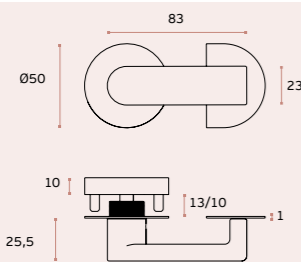

Furação para painel fenólico /
 Drilling for phenolic panel /
 Talladro para panel fenólico.

1- Botão de fecho com sistema de montagem rápida /

Locking button with quick assembling system /
 Botón de bloqueo con sistema de montaje rápido.

2- Anilha anti-fricção /

Anti friction washer / Arandella anti fricción.

3- Espelho em aço inox /

Stainless steel cover / Roseta en acero inox.

4- Indicador livre/ocupado (pode ser optado na instalação) /

Indicator for snib indicator (can be choosen on instalation) /
 Indicador de cierre baño (opcional en la instalacion).

5- Chave para desbloqueio /

Unlocking key / Llave de desbloqueo

6- Fecho exterior / Outside Lock / Cierre exterior.

7- Chapa testa em aço inox EN 1.4301 /

Strike plate made in stainless steel EN 1.4301 /

Cerradero en acero inox EN 1.4301

8- Chave para remoção do botão /

Key to remove the button / Llave para quitar el botón.

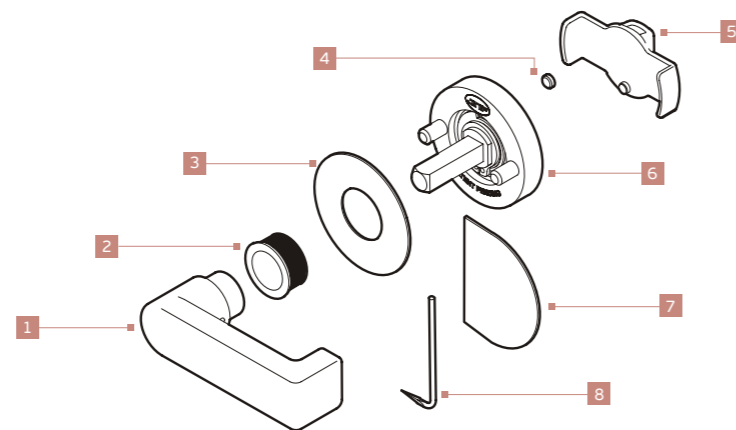

EASY FIX

INSTALLATION IN
7 SECONDS

SISTEMAS MODULARES PARA CABINES SANITÁRIAS / SANITARY BOOTH HARDWARE / HERRAJES PARA CABINAS SANITÁRIAS.

SM.060

Fecho com indicador "livre-ocupado" /
 Bathroom latch with indicator /
 Cierre de baño con indicador.

.TB .TG .TCO .TCH

MATERIAL: EN 1.4301 / AISI 304

ACABAMENTO / FINISH / ACABADO:
 STANDARD: SATINADO / SATIN / SATIN

OPTIONAL: PVD TITANIUM COATED

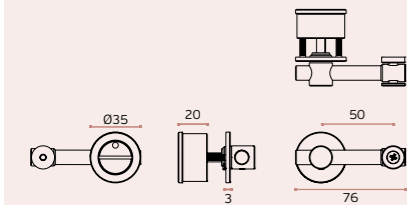

Titanium Black Titanium Gold



Titanium Copper Titanium Chocolate



Titanium Black



Titanium Gold



Titanium Copper



Titanium Chocolate

SM.026

Fecho com indicador "livre-ocupado" /
 Bathroom latch with indicator /
 Cierre de baño con indicador..

MATERIAL: EN 1.4301 / AISI 304

ACABAMENTO / FINISH / ACABADO:
 STANDARD: SATINADO / SATIN / SATIN

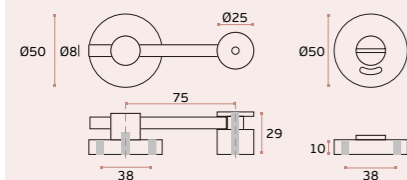

SM.035

Fecho /
 Bolt /
 Pasador.

.TB .TG .TCO .TCH

MATERIAL: EN 1.4301 / AISI 304

ACABAMENTO / FINISH / ACABADO:
 STANDARD: SATINADO / SATIN / SATIN

OPTIONAL: PVD TITANIUM COATED

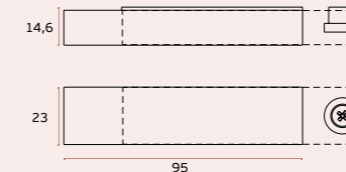

SM.027

Fecho para wc com indicador "livre-ocupado"
 para portas de correr /
 Bathroom latch for sliding door with indicator /
 Cierre de baño para puertas correderas
 con indicador.

MATERIAL: EN 1.4301 / AISI 304

ACABAMENTO / FINISH / ACABADO:
 STANDARD: SATINADO / SATIN / SATIN

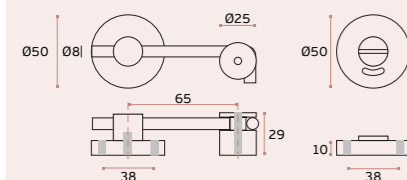

SM.035.P

Fecho /
 Bolt /
 Pasador.

MATERIAL: EN 1.4301 / AISI 304

ACABAMENTO / FINISH / ACABADO:
 STANDARD: POLIDO / MIRROR / PULIDO

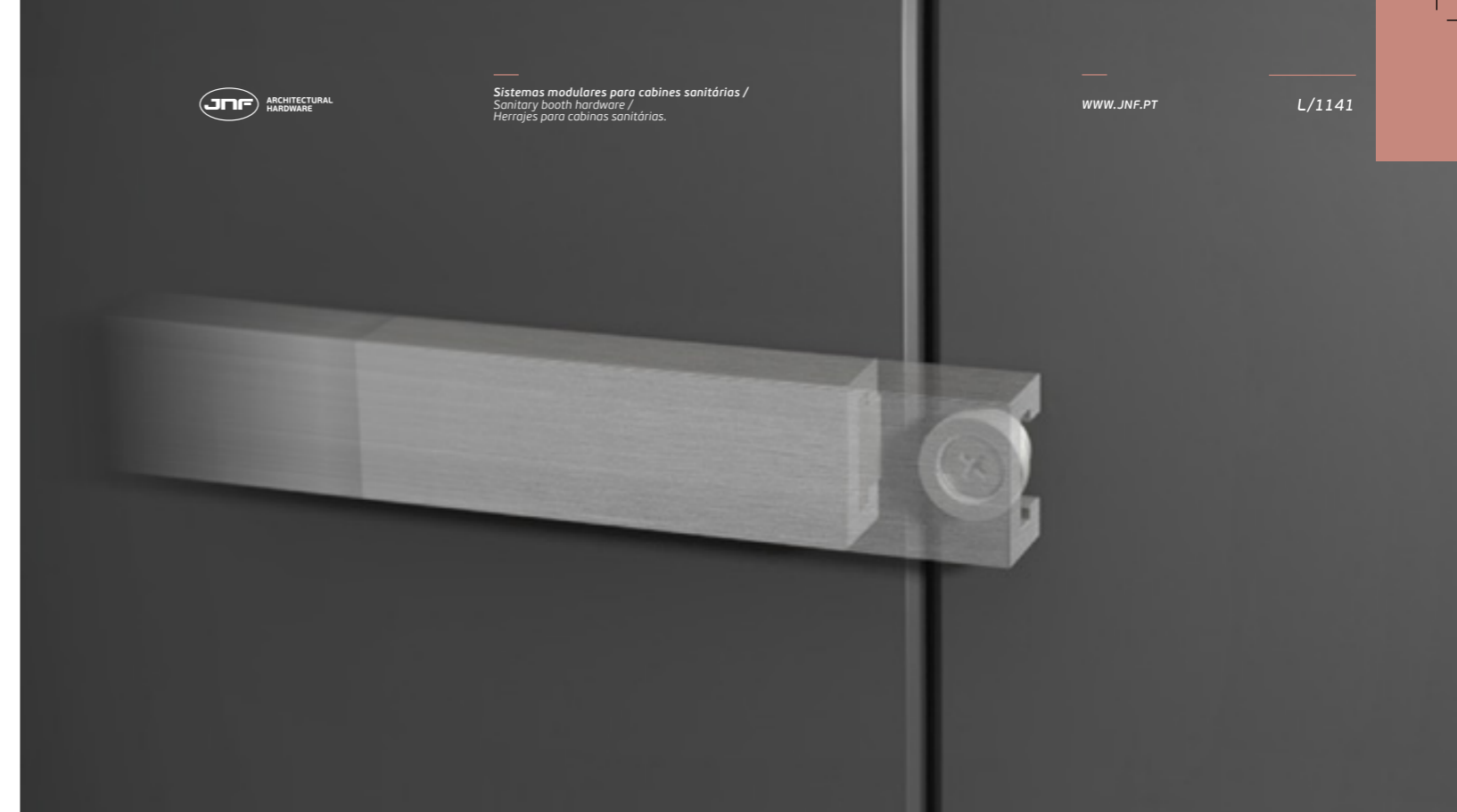
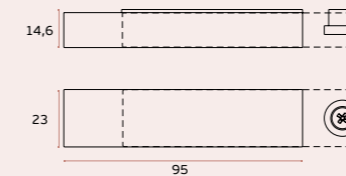

SISTEMAS MODULARES PARA CABINES SANITÁRIAS / SANITARY BOOTH HARDWARE / HERRAJES PARA CABINAS SANITÁRIAS.

SM.029

Fecho com indicador "livre-ocupado" /
 Bathroom latch with indicator /
 Cierre de baño con indicador.

MATERIAL: EN 1.4301 / AISI 304

ACABAMENTO / FINISH / ACABADO:
STANDARD: SATINADO / SATIN / SATIN

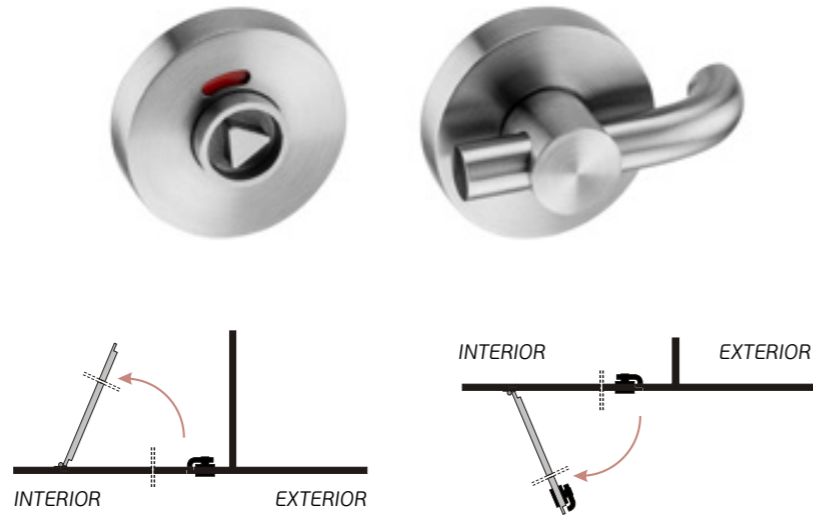
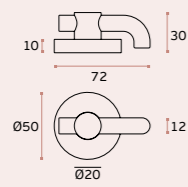

IN.04.251
Chave
triangular/
 Triangular
 key /
 Llave
 triangular.



IN.17.616

Fecho com indicador de cor /
 Slide bolt with color indicator /
 Cierre con indicador de color.

MATERIAL: EN 1.4301 / AISI 304

ACABAMENTO / FINISH / ACABADO:
STANDARD: SATINADO / SATIN / SATIN

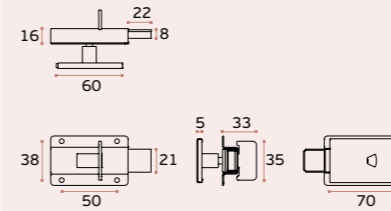

SM.030

Fecho para wc com indicador "livre-ocupado" /
 Bathroom latch with indicator /
 Cierre de baño con indicador.

MATERIAL: EN 1.4301 / AISI 304

ACABAMENTO / FINISH / ACABADO:
STANDARD: SATINADO / SATIN / SATIN

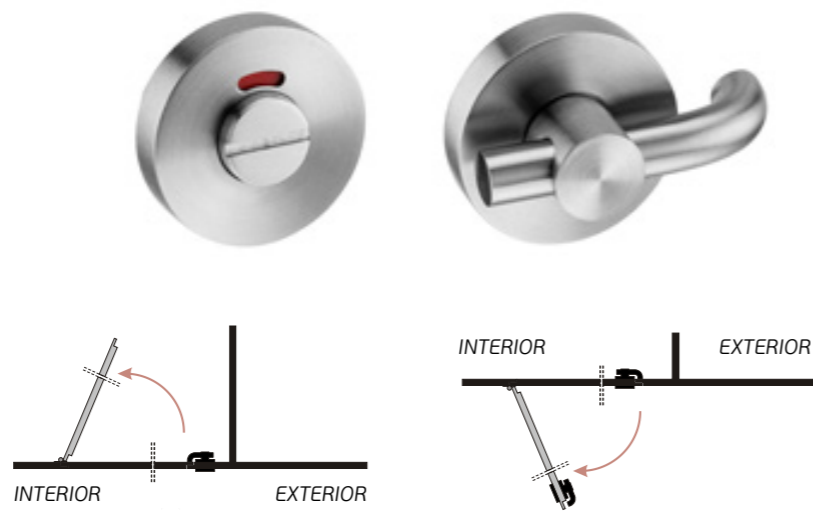
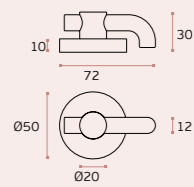

IN.17.617

Fecho sem indicador de cor /
 Slide bolt without color indicator /
 Cierre sin indicador de color.

MATERIAL: EN 1.4301 / AISI 304

ACABAMENTO / FINISH / ACABADO:
STANDARD: SATINADO / SATIN / SATIN

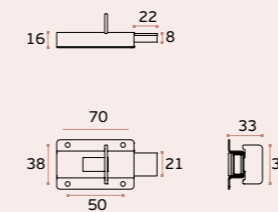

SM.051

Fecho para wc com indicador "livre-ocupado" /
 Bathroom latch with indicator /
 Cierre de baño con indicador.

MATERIAL: EN 1.4301 / AISI 304

ACABAMENTO / FINISH / ACABADO:
STANDARD: SATINADO / SATIN / SATIN

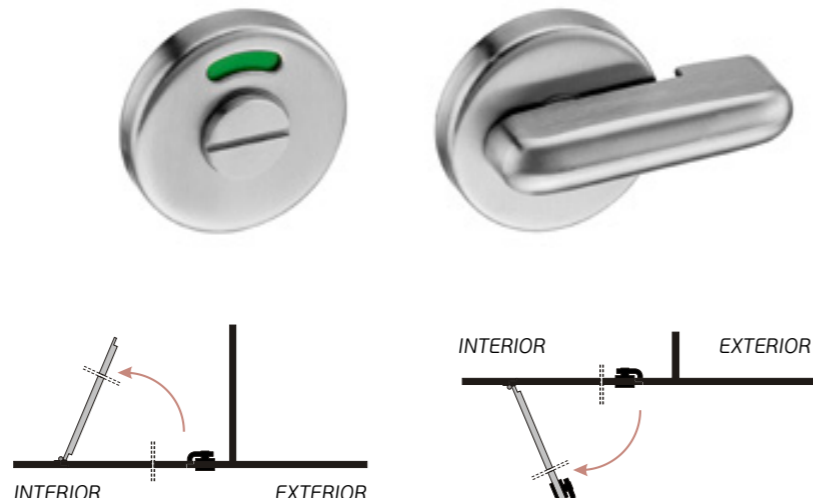
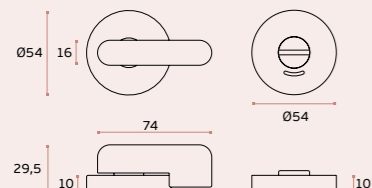

SM.02039

Fecho com indicador "livre-ocupado" /
 bathroom latch with indicator /
 Cierre de baño con indicador.

MATERIAL: ZAMAK / ZINC ALLOY

ACABAMENTO / FINISH / ACABADO:
COR INOX / INOX COLOR / COLOR INOX

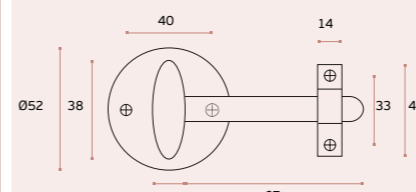

SISTEMAS MODULARES PARA CABINES SANITÁRIAS / SANITARY BOOTH HARDWARE / HERRAJES PARA CABINAS SANITÁRIAS.

IN.75.040

Puxador de porta duplo anti-vandalismo /
 Double door knob with anti-vandalism fixing /
 Tirador de puerta doble anti-vandalismo.

.TB .TG .TCO .TCH

MATERIAL: EN 1.4301 / AISI 304

ACABAMENTO / FINISH / ACABADO:
STANDARD: SATINADO / SATIN / SATIN

OPTIONAL: PVD TITANIUM COATED

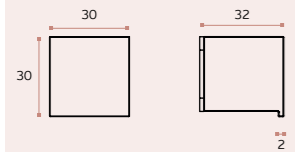

IN.75.041

Puxador de porta duplo anti-vandalismo /
 Double door knob with anti-vandalism fixing /
 Tirador de puerta doble anti-vandalismo.

.TB .TG .TCO .TCH

MATERIAL: EN 1.4301 / AISI 304

ACABAMENTO / FINISH / ACABADO:
STANDARD: SATINADO / SATIN / SATIN

OPTIONAL: PVD TITANIUM COATED

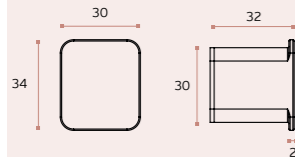

IN.75.042

Puxador de porta duplo anti-vandalismo /
 Double door knob with anti-vandalism fixing /
 Tirador de puerta doble anti-vandalismo.

.TB .TG .TCO .TCH

MATERIAL: EN 1.4372 / AISI 304

ACABAMENTO / FINISH / ACABADO:
STANDARD: SATINADO / SATIN / SATIN

OPTIONAL: PVD TITANIUM COATED

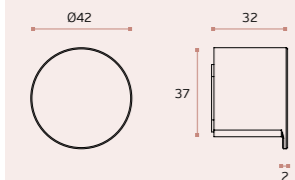

IN.75.030

Puxador para portas de vidro
ou fenólico / Knobs for glass or
phenolic doors / Pomos para puerta
de cristal o fenolico .

MATERIAL: EN 1.4301 / AISI 304

ACABAMENTO / FINISH / ACABADO:
STANDARD: SATINADO / SATIN / SATIN



IN.75.051.D

Puxador de porta duplo
anti-vandalismo / Double door knob
with anti-vandalism fixing / Tirador de
puerta doble anti-vandalismo.

.TB .TG .TCO .TCH

MATERIAL: EN 1.4301 / AISI 304

STANDARD FINISH:
 SATINADO / SATIN / SATIN

OPTIONAL: PVD TITANIUM COATED

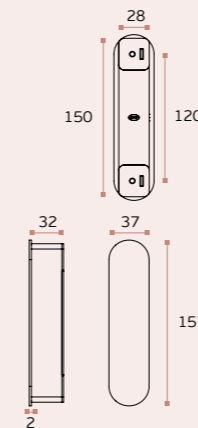

IN.75.050.D

Puxador de porta duplo
anti-vandalismo / Double door knob
with anti-vandalism fixing / Tirador de
puerta doble anti-vandalismo.

.TB .TG .TCO .TCH

MATERIAL: EN 1.4301 / AISI 304

STANDARD FINISH:
 SATINADO / SATIN / SATIN

OPTIONAL: PVD TITANIUM COATED

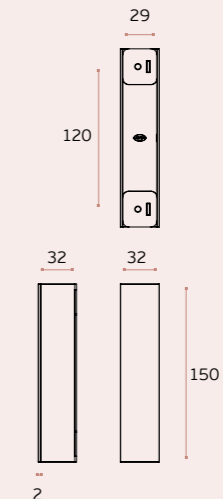

SM.019

Puxador de porta duplo anti-
vandalismo / Double door knob with
anti-vandalism fixing / Tirador de puerta
doble anti-vandalismo.

MATERIAL: EN 1.4301 / AISI 304

ACABAMENTO / FINISH / ACABADO:
STANDARD: SATINADO / SATIN / SATIN



SM.020

Puxador de porta duplo anti-
vandalismo / Double door knob with
anti-vandalism fixing / Tirador de
puerta doble anti-vandalismo.

MATERIAL: EN 1.4372 / AISI 201

ACABAMENTO / FINISH / ACABADO:
STANDARD: SATINADO / SATIN / SATIN

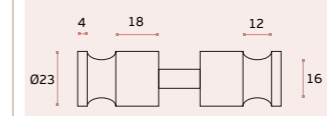

SISTEMAS MODULARES PARA CABINES SANITÁRIAS / SANITARY BOOTH HARDWARE / HERRAJES PARA CABINAS SANITÁRIAS.

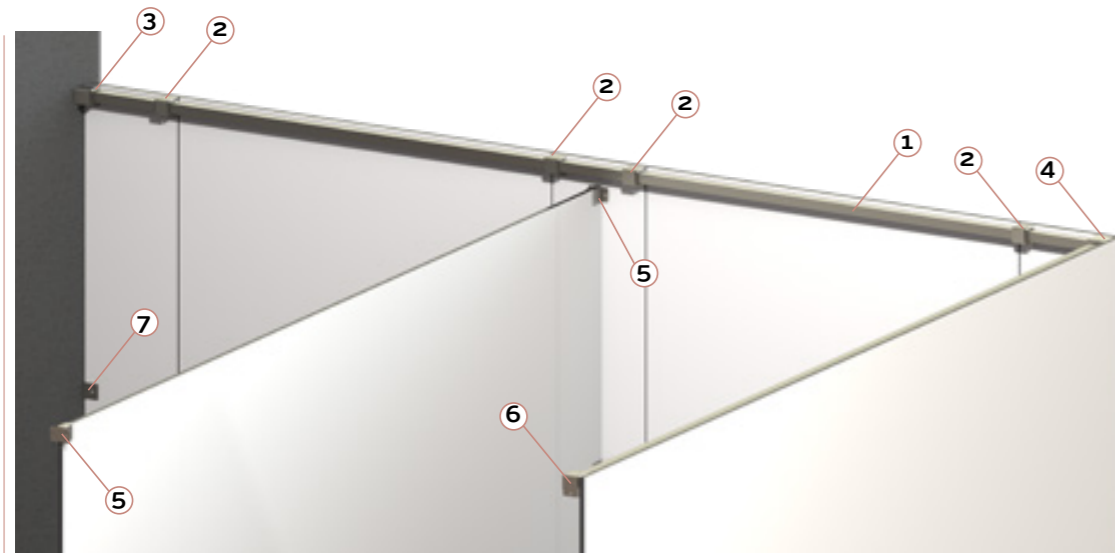
**20X20
mm**

- 1 - SM.010.Q.20
- 2 - SM.063
- 3 - SM.064.D
- 4 - SM.062
- 5 - SM.061
- 6 - SM.064.E
- 7 - SM.065



**Ø25
mm**

SM.062 Suporte superior para painel 90° / Upper panel holder 90° / Soporte superior para panel 90°.

.TB .TG .TCO .TCH

MATERIAL: EN 1.4301 / AISI 304

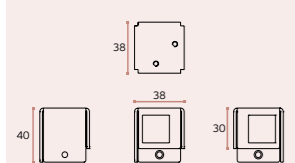
ACABAMENTO / FINISH / ACABADO:
 STANDARD: SATINADO / SATIN / SATIN

OPTIONAL: PVD TITANIUM COATED

**20X20
mm**

SM.064.D / SM.064.E Suporte superior para painel / Upper panel holder / Soporte superior para panel.

.TB .TG .TCO .TCH

MATERIAL: EN 1.4301 / AISI 304

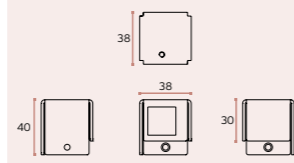
ACABAMENTO / FINISH / ACABADO:
 STANDARD: SATINADO / SATIN / SATIN

OPTIONAL: PVD TITANIUM COATED

**20X20
mm**

SM.002 Suporte superior para painel / Upper panel holder / Soporte superior para panel.

.TB .TG .TCO .TCH

MATERIAL: EN 1.4301 / AISI 304

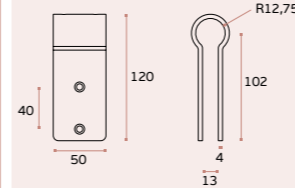
ACABAMENTO / FINISH / ACABADO:
 STANDARD: SATINADO / SATIN / SATIN

OPTIONAL: PVD TITANIUM COATED

**Ø25
mm**

SM.002.ECO Suporte superior para painel / Upper panel holder / Soporte superior para panel.

.TB .TG .TCO .TCH

MATERIAL: EN 1.4372 / AISI 201

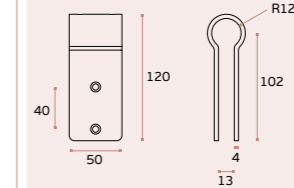
ACABAMENTO / FINISH / ACABADO:
 STANDARD: SATINADO / SATIN / SATIN

OPTIONAL: PVD TITANIUM COATED

**Ø25
mm**

SM.063 Suporte superior para painel / Upper panel holder / Soporte superior para panel.

.TB .TG .TCO .TCH

MATERIAL: EN 1.4301 / AISI 304

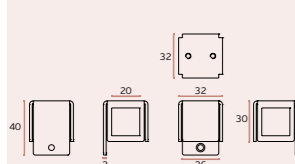
ACABAMENTO / FINISH / ACABADO:
 STANDARD: SATINADO / SATIN / SATIN

OPTIONAL: PVD TITANIUM COATED

**20X20
mm**

SM.10.Q.20 Tubo quadrado 20x20mm (3000mm) / Square tube 20x20mm (3000mm) / Tubo cuadrado 20x20mm (3000mm)

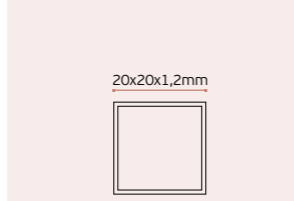
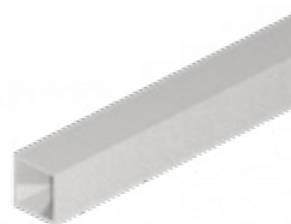
MATERIAL: EN 1.4301 / AISI 304

ACABAMENTO / FINISH / ACABADO:
 STANDARD: SATINADO / SATIN / SATIN

**20X20
mm**

SM.012.90 Suporte superior para painel / Upper panel holder / Soporte superior para panel.

MATERIAL: EN 1.4301 / AISI 304

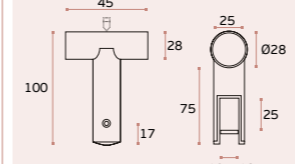
ACABAMENTO / FINISH / ACABADO:
 STANDARD: SATINADO / SATIN / SATIN

OPTIONAL: PVD TITANIUM COATED

**Ø25
mm**

SM.012.180 Suporte superior para painel / Upper panel holder / Soporte superior para panel.

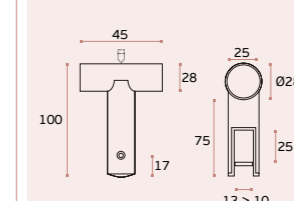
MATERIAL: EN 1.4301 / AISI 304

ACABAMENTO / FINISH / ACABADO:
 STANDARD: SATINADO / SATIN / SATIN

**Ø25
mm**



SISTEMAS MODULARES PARA CABINES SANITÁRIAS / SANITARY BOOTH HARDWARE / HERRAJES PARA CABINAS SANITÁRIAS.

SM.010.A.19.3000

Tubo Ø19mm /
 Tube Ø19mm /
 Tubo Ø19mm.

MATERIAL: EN 1.4301 / AISI 304

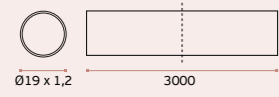
ACABAMENTO / FINISH / ACABADO:
 STANDARD: SATINADO / SATIN / SATIN



Ø19
mm

SM.010.A.19.2000

Tubo Ø19mm /
 Tube Ø19mm /
 Tubo Ø19mm.

.TB .TG .TCO .TCH

MATERIAL: EN 1.4301 / AISI 304

ACABAMENTO / FINISH / ACABADO:
 STANDARD: SATINADO / SATIN / SATIN

OPTIONAL: PVD TITANIUM COATED

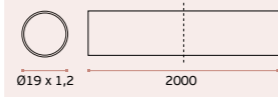

Ø19
mm



SM.011.19

Suporte de tubo com fixação à
 parede / Wall mounting tube support /
 Soporte de tubo con sujeción a pared.

.TB .TG .TCO .TCH

MATERIAL: EN 1.4301 / AISI 304

ACABAMENTO / FINISH / ACABADO:
 STANDARD: SATINADO / SATIN / SATIN

OPTIONAL: PVD TITANIUM COATED

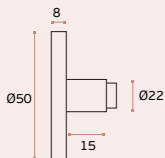

Ø19
mm



SM.010.C.19

Conector para tubo Ø19mm /
 Tube connector Ø19mm /
 Conector de tubo Ø19mm.

MATERIAL: ALUMINIO / ALUMINIUM

ACABAMENTO / FINISH / ACABADO:
 STANDARD: SATINADO / SATIN / SATIN

OPTIONAL: PVD TITANIUM COATED



Ref.	X
SM.010.C - Ø19	16



SM.032.19

União de tubo a 90° para tubo de
 Ø19mm / Tube connector at 90° for
 Ø19mm tube / Union de tubo a 90°
 para tubo Ø19mm.

.TB .TG .TCO .TCH

MATERIAL: EN 1.4301 / AISI 304

ACABAMENTO / FINISH / ACABADO:
 STANDARD: SATINADO / SATIN / SATIN

OPTIONAL: PVD TITANIUM COATED

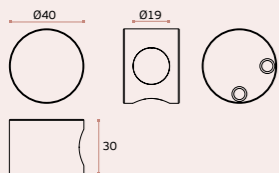

Ø19
mm

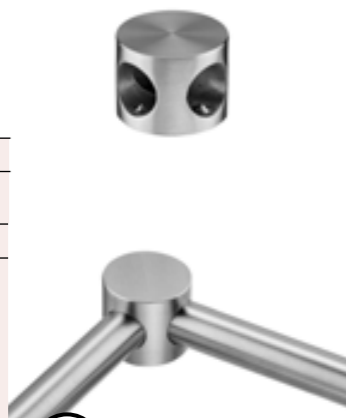

SM.033.19

União de tubo a 90° e a 180° para
 tubo de Ø19mm / Tube connector at 90°
 and 180° for Ø19mm tube / Union de tubo a
 90° y 180° para tubo de Ø19mm.

.TB .TG .TCO .TCH

MATERIAL: EN 1.4301 / AISI 304

ACABAMENTO / FINISH / ACABADO:
 STANDARD: SATINADO / SATIN / SATIN

OPTIONAL: PVD TITANIUM COATED

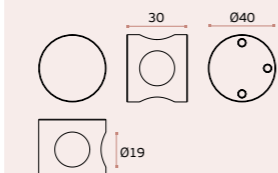

Ø19
mm



SM.014

Suporte para painel /
 Panel holder /
 Soporte para panel.

MATERIAL: EN 1.4301 / AISI 304

ACABAMENTO / FINISH / ACABADO:
 STANDARD: SATINADO / SATIN / SATIN

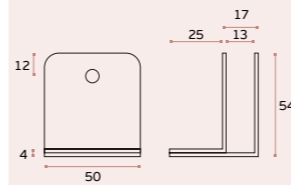

SM.034

Suporte para painel /
 Panel holder /
 Soporte para panel.

MATERIAL: EN 1.4372 / AISI 304

ACABAMENTO / FINISH / ACABADO:
 STANDARD: SATINADO / SATIN / SATIN

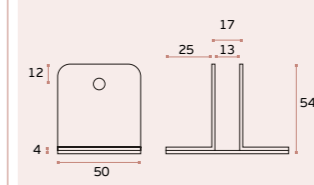

SM.044

Suporte para painel /
 Panel holder /
 Soporte para panel.

.TB .TG .TCO .TCH

MATERIAL: EN 1.4301 / AISI 304

ACABAMENTO / FINISH / ACABADO:
 STANDARD: SATINADO / SATIN / SATIN

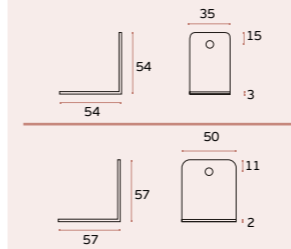

SM.024

Suporte para painel /
 Panel holder /
 Soporte para panel.

.TB .TG .TCO .TCH

MATERIAL: EN 1.4301 / AISI 304

ACABAMENTO / FINISH / ACABADO:
 STANDARD: SATINADO / SATIN / SATIN

OPTIONAL: PVD TITANIUM COATED

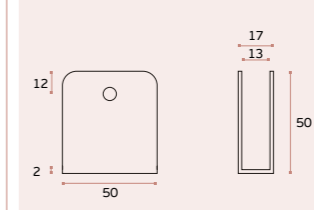

SM.065

Suporte para painel /
 Panel holder /
 Soporte para panel.

.TB .TG .TCO .TCH

MATERIAL: EN 1.4301 / AISI 304

ACABAMENTO / FINISH / ACABADO:
 STANDARD: SATINADO / SATIN / SATIN

OPTIONAL: PVD TITANIUM COATED

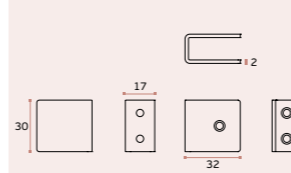

SM.061

Suporte para painel /
 Panel holder /
 Soporte para panel.

.TB .TG .TCO .TCH

MATERIAL: EN 1.4301 / AISI 304

ACABAMENTO / FINISH / ACABADO:
 STANDARD: SATINADO / SATIN / SATIN

OPTIONAL: PVD TITANIUM COATED

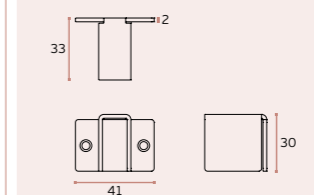

SISTEMAS MODULARES PARA CABINES SANITÁRIAS / SANITARY BOOTH HARDWARE / HERRAJES PARA CABINAS SANITÁRIAS.

SM.103

Perfil em "U" para painel de 13 mm /
 "U" shape profile for 13mm panel /
 Perfil en "U" para panel de 13mm.

MATERIAL: ALUMÍNIO / ALUMINIUM

ACABAMENTO / FINISH / ACABADO:
STANDARD: SATINADO / SATIN / SATIN

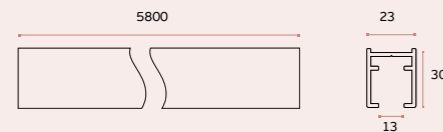
**SM.101**

Perfil em "U" para painel de 13 mm /
 "U" shape profile for 13 mm panel /
 Perfil en "u" para panel de 13 mm.

MATERIAL: EN 1.4301 / AISI 304

ACABAMENTO / FINISH / ACABADO:
STANDARD: SATINADO / SATIN / SATIN

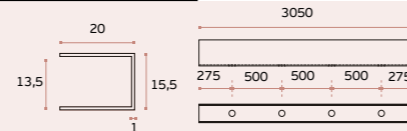
**SM.101.AL**

Perfil em "U" para painel até 13 mm /
 "U" shape profile until 13mm panel /
 Perfil en "U" para panel de 13mm.

MATERIAL: ALUMÍNIO / ALUMINIUM

ACABAMENTO / FINISH / ACABADO:
STANDARD: SATINADO / SATIN / SATIN

**SM.104.AL**

Perfil em "U" para painel de 10mm /
 "U" shape profile for 10mm panel /
 Perfil en "U" para panel de 10mm.

MATERIAL: ALUMÍNIO / ALUMINIUM

ACABAMENTO / FINISH / ACABADO:
STANDARD: SATINADO / SATIN / SATIN

**SM.102.AL**

Perfil em "U" para painel de 10mm /
 "U" shape profile for 10mm panel /
 Perfil en "U" para panel de 10mm.

MATERIAL: ALUMÍNIO / ALUMINIUM

ACABAMENTO / FINISH / ACABADO:
STANDARD: SATINADO / SATIN / SATIN

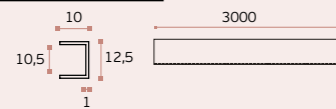
**SM.102**

Perfil em "U" para painel de 10mm /
 "U" shape profile for 10mm panel /
 Perfil en "U" para panel de 10mm.

MATERIAL: EN 1.4301 / AISI 304

ACABAMENTO / FINISH / ACABADO:
STANDARD: SATINADO / SATIN / SATIN

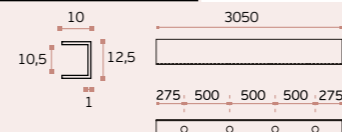
**SM.042.A SM.042.B**

Parafuso de ligação para
 acessórios de fenólico / Screw
 connection for phenolic accessories
 / Tornillo pasante de conexión para
 accesorios de fenolico.

**SM.040**

Parafuso de ligação para
 acessórios de fenólico / Screw
 connection for phenolic accessories
 / Tornillo pasante de conexión para
 accesorios de fenolico.

**SM.041**

Parafuso de ligação para
 acessórios de fenólico / Screw
 connection for phenolic accessories
 / Tornillo pasante de conexión para
 accesorios de fenolico.

**SM.042.E SM.042.F**

Parafuso e bucha de nylon /
 Screw and nylon plug /
 Tornillo e taco de nylon.

**IN.14.520.AL**
Cabide /
Hook / Percha.

MATERIAL: ALUMÍNIO / ALUMINIUM /
ALUMINIO

ACABAMENTO / FINISH / ACABADO:
SATINADO / SATIN / SATIN

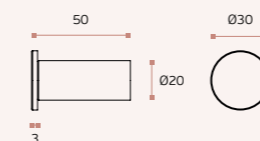

IN.14.520.AL.SB



IN.14.520.AL.SG



IN.14.520.AL.SC

**IN.14.521.AL**
Cabide /
Hook / Percha.

MATERIAL: ALUMÍNIO / ALUMINIUM /
ALUMINIO

ACABAMENTO / FINISH / ACABADO:
SATINADO / SATIN / SATIN

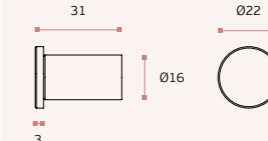

IN.14.521.AL.SB



IN.14.521.AL.SG



IN.14.521.AL.SC

SISTEMAS MODULARES PARA CABINES SANITÁRIAS / SANITARY BOOTH HARDWARE / HERRAJES PARA CABINAS SANITÁRIAS.



IN.14.530.ECO
 Cabide duplo / Double hook /
 Colgador doble.

ECO
 series



MATERIAL: EN 1.4372 / AISI 201

ACABAMENTO / FINISH / ACABADO: SATIN

OPTIONAL: PVD TITANIUM COATED

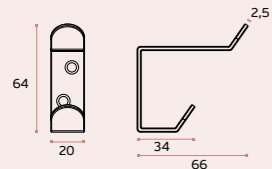

IN.14.529.ECO
 Cabide duplo com batente de porta /
 Double hook with door stopper /
 Colgador doble con tope de puerta.

ECO
 series

MATERIAL: EN 1.4372 / AISI 201

ACABAMENTO / FINISH / ACABADO:
 STANDARD: SATINADO / SATIN / SATIN

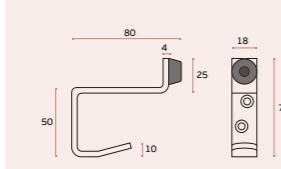

IN.14.546
 Cabide /
 Hook / Percha.

MATERIAL: EN 1.4401 / AISI 316

ACABAMENTO / FINISH / ACABADO: RAW

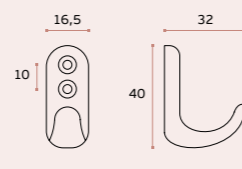

IN.14.546.F
 Cabide /
 Hook / Percha.

MATERIAL: EN 1.4401 / AISI 316

ACABAMENTO / FINISH / ACABADO: RAW

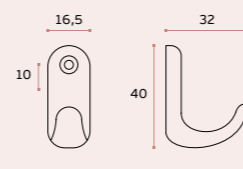

Sistema para cabines sanitárias especialmente desenvolvido para pessoas com mobilidade reduzida.
 Sistema de porta de correr para painéis fenólicos de 13mm. O sistema de fecho está preparado para utilizadores com mobilidade reduzida e um sistema de segurança que permite desbloquear o fecho pelo exterior em caso de qualquer emergência.

System for sanitary cabinets specially designed for disabled people.
 Sliding door system for phenolic panels with 13mm. The lock system is ready for users with reduced mobility and it's provided with a security system to unlock the system from the outside in case of any emergency.

Sistema para cabinas sanitarias especialmente diseñado para personas con movilidad reducida.
 Sistema de puertas correderas de paneles fenólicos con 13mm. El sistema de cierre está valido para los usuarios con movilidad reducida, tiene un sistema de seguridad para desbloquear el sistema por el exterior en caso de cualquier emergencia.



SM.008
 Cabide / Batente de porta anti-vandalismo / Hook / Door stopper concealed fixing / Percha / Tope te puerta anti-vandalismo.

MATERIAL: EN 1.4301 / AISI 304

ACABAMENTO / FINISH / ACABADO:
 STANDARD: SATINADO / SATIN / SATIN

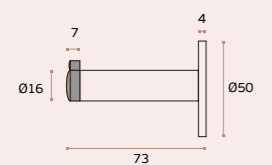

IN.14.541
 Cabide /
 Hook / Percha.

MATERIAL: EN 1.4301 / AISI 304

ACABAMENTO / FINISH / ACABADO:
 SATINADO / SATIN / SATIN

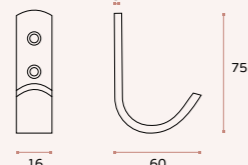

IN.14.030
 Cabide / Hook / Percha.
 Design: Pedro Queirós

MATERIAL: EN 1.4301 / AISI 304

ACABAMENTO / FINISH / ACABADO:
 SATINADO / SATIN / SATIN

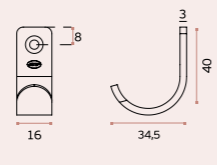

IN.14.010
 Cabide / Hook / Percha.
 Design: Pedro Queirós

MATERIAL: EN 1.4301 / AISI 304

ACABAMENTO / FINISH / ACABADO:
 SATINADO / SATIN / SATIN

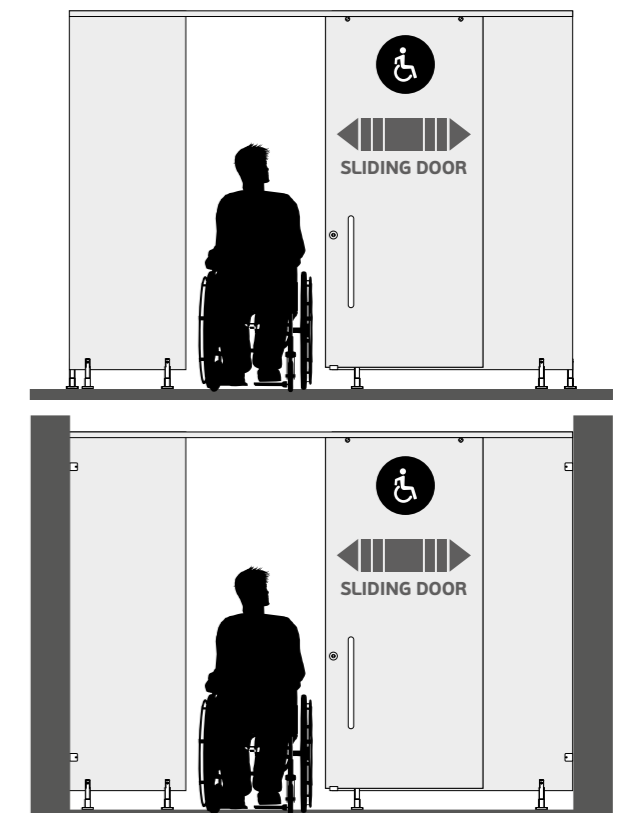
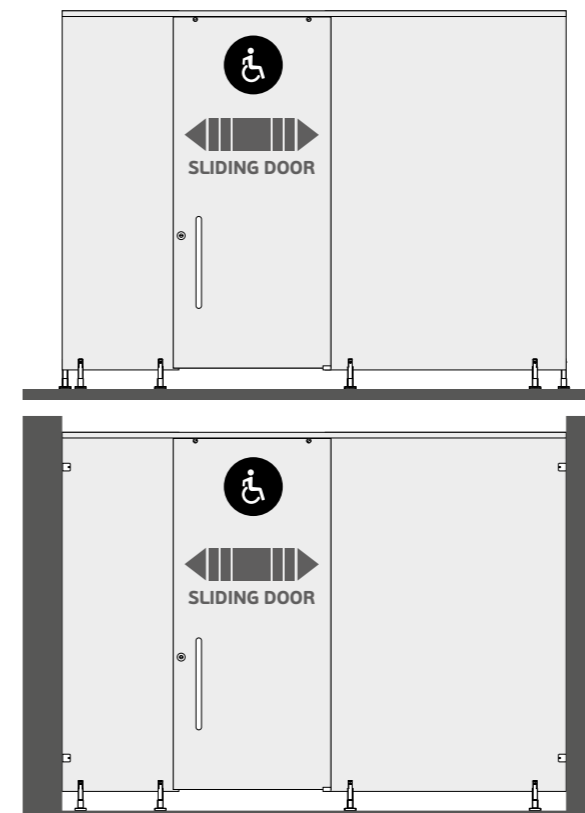
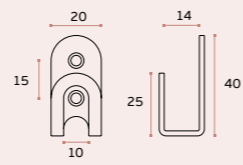

SISTEMAS MODULARES PARA CABINES SANITÁRIAS / SANITARY BOOTH HARDWARE / HERRAJES PARA CABINAS SANITÁRIAS.



IN.15.258

Sistema completo de porta de correr para
cabines em HPL
Inclui:

Calha de alumínio 2900mm (pode ser cortada) /
(x2) Roldanas com suporte para fenólico /
(x2) Suportes de parede /
(x1) Guia inferior para fenólico /

Espessuras de fenólico: 10-13mm.
Largura máx. da porta: 1500mm
Peso máx. da porta: 60Kg

(Porta, puxador e fechadura não incluídos)

Complete sliding door system
for HPL cabinets
Includes:

Aluminium track 2900mm (can be cutted) /
(x2) Wheels with phenolic support /
(x2) Wall supports /
(x1) Lower guide to phenolic /

Phenolic thickness: 10-13mm.
Max. door length: 1500mm
Max. door weight: 60Kg

(Door, handle and lock not included.)

Sistema completo para puertas correderas
para cabinas em HPL
Incluido:

Guia en aluminio 2900mm (puede ser cortada).
(x2) Ruedas con soporte para fenólico.
(x2) Soportes de pared.
(x1) Guia de bajo para fenólico.

Espesor de lo fenólico: 10-13mm.
Anchura max. de la puerta: 1500mm
Peso max. de la puerta: 60kg

(Puerta, manilla y cerradura no incluidas.)

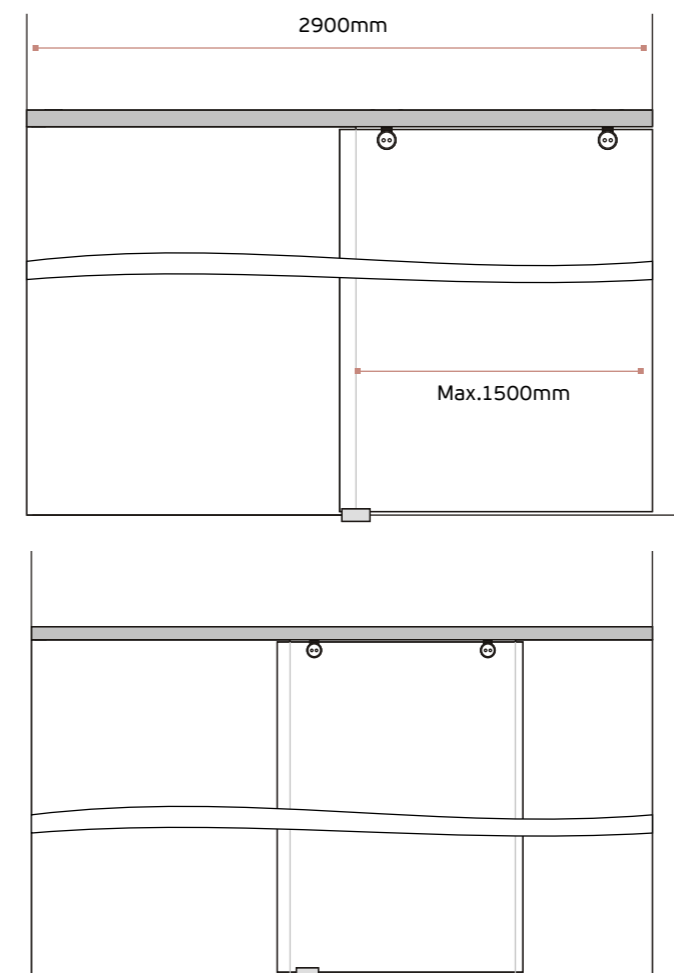

Medidas dos furos a efectuar na porta do fenólico /
SIZES OF THE HOLES TO BE MADE IN THE PHENOLIC DOOR /
Medidas de los taladros en la puerta en fenólico.

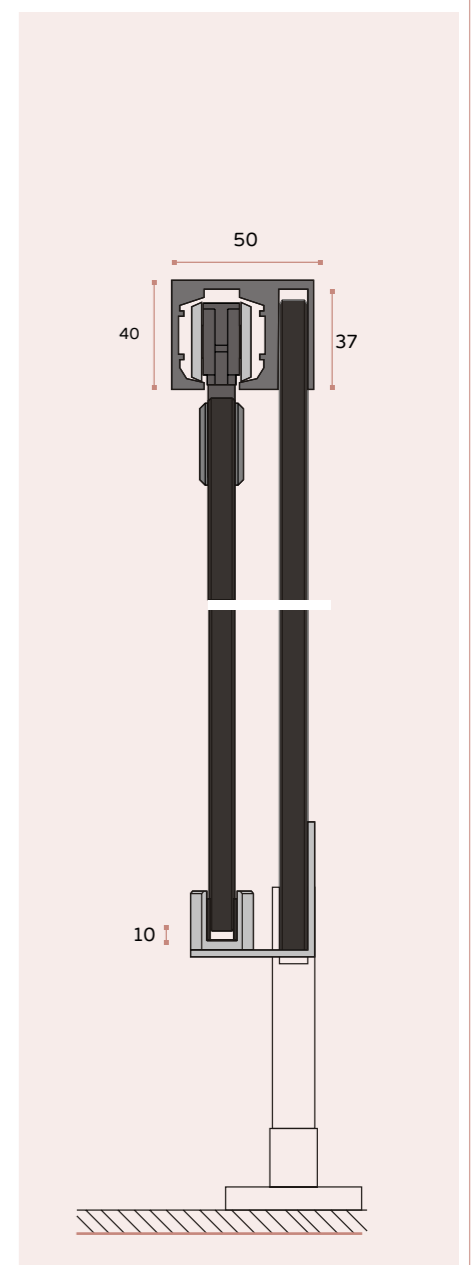
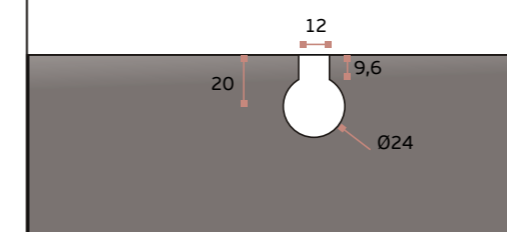

SISTEMAS MODULARES PARA CABINES SANITÁRIAS / SANITARY BOOTH HARDWARE / HERRAJES PARA CABINAS SANITÁRIAS.

SM.036

Fechadura para portas de correr, para aplicar com fecho livre-ocupado. Testa para parede incluída / Lock for sliding door to use with snib indicator. Strike plate included / Cerradura para puertas correderas para aplicar con condena de baño. Cerradero incluido.



MATERIAL: EN 1.4301 / AISI 304

STANDARD FINISH: SATINADO / SATIN / SATIN

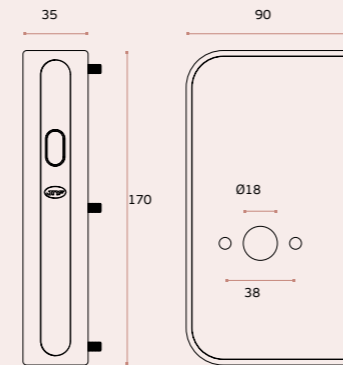

SM.037

Fechadura para portas de correr, para aplicar com cilindro. Testa para parede incluída / Lock for sliding door to use with european cylinder. Strike plate included. Cerradura para puertas correderas para aplicar con bombillo. Cerradero incluido.



MATERIAL: EN 1.4301 / AISI 304

STANDARD FINISH: SATINADO / SATIN / SATIN

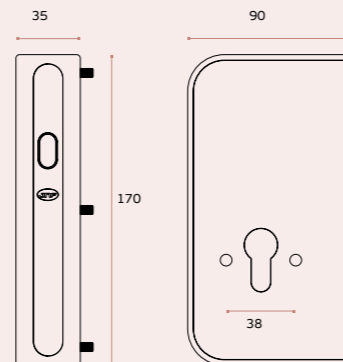

SM.038

Testa para aplicar com SM.036 e SM.037 (não incluída) / Strike plate to use with SM.036 and SM.037 (not included) / Cerradero para aplicar con SM.036 y SM.03 (no incluido).



MATERIAL: EN 1.4301 / AISI 304

STANDARD FINISH: SATINADO / SATIN / SATIN

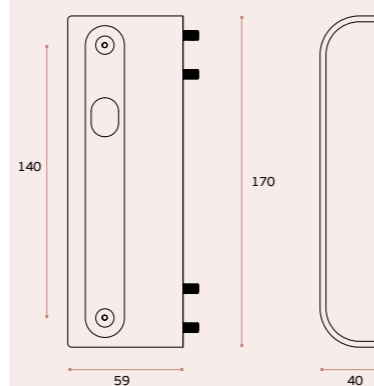

IN.04.110

Fecho para wc com ranhura para moeda / Bathroom snib indicator with coin slot / Condena de baño con fenda para moneda.

MATERIAL: EN 1.4301 / AISI 304

ACABAMENTO / FINISH / ACABADO:
 STANDARD: SATINADO / SATIN / SATIN

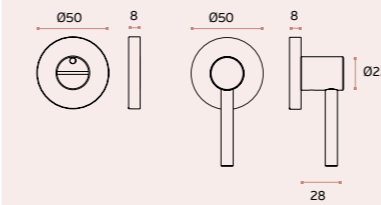

IN.19.523.

Chaves diferentes / Different key / Llaves distintas



IN.19.524.

Chaves diferentes / Different key / Llaves distintas



IN.19.526.B2 / B3 / B4 / B6 / B7

Cilindro de perfil europeu com fenda para moeda de um lado e botão em aço inox do outro. 6 modelos disponíveis / European profile cylinder with coin slot in one side and stainless steel button in opposite side. 6 models available / Cilindro de perfil europeo con fenda para moneda en un lado y botón en acero inoxidable por el otro. 6 modelos disponibles.



BOTÕES DIPONIVEIS

Available knobs / Pomos disponibles

